

**WARNING**



**Important Safety Instructions:**

Read all warnings and instructions in this manual. Save these instructions.

**Vigtigt!**

Læs denne manual grundigt før brug.  
Gem manualen til senere brug.

Must be grounded when use this pump:: Read Grounding instructions. Use only grounded electrical outlets or Ground equipment and conductive objects in work area.

Benyt altid jordet stikudtag, stikkontakter, forlængere og forgrener udstyr.

Maskinen kræver jordforbindelse.



**VOLTAGE**  
POWERTOOLS  
BY DVA

When unpacking, make sure that the product is intact and undamaged. If any parts are missing or broken, Please contact to where you buy this product.

Ved udpakning, bemærk venligst om produktet er intakt og uskadet. Hvis der mangler dele eller dele er skadet, kontakt venligst din forhandler.



# Voltage Airless Spraymaster

## Indhold

- 3 Quick-start guide
- 7 Quick-guide til rensning
- 9 Grundlæggende forholdsregler og advarsler
- 13 Tekniske data
- 13 Brugsvejledning
- 15 Service og reparation
- 15 El installation Tegning
- 16 Splittegning
- 17 Reservedelsliste

**For English instructions see page 18**

# QUICK START GUIDE

Kom hurtigt i gang med din malersprøjte med denne quick-start guide. Husk altid at læse hele brugsanvisningen før start.

Tillykke med din nye Voltage Airless Paintmaster malersprøjte. Vi vil gerne hjælpe dig hurtigt i gang, så start med at følge de næste trin.



Pak maskinen ud af kassen og læg alle delene frem, så du kan danne et overblik.

**(Bemærk at ring gaffelnøgler ikke medfølger i kassen)**



Til samling af maskinen, skal du bruge 2 stk. 19 mm. gaffel nøgler, eller justerbare nøgler, til adskillelse skal der derudover bruges en 16mm nøgle.

**(Bemærk at ring gaffelnøgler ikke medfølger i kassen)**



Inden samling af maskinen, kontroller da venligst at pistolen er komplet.

Der medfølger udover komplet pistol;

1 stk. ekstra gummipakning for pistol.

1 stk. filter til pistol.

1 stk. børste til rensning af pistol og maskine.



Hvis Pistolen er komplet, kontroller da venligst at den blå dysebeskytter er strammet godt til pistolen inden De fortsætter (værktøj er ikke nødvendigt).



Fastgør slangen til studsene på maskinen og studsene på pistolen, ved brug af 19mm gaffelnøgler (figure4+figure5).



Maskinen er nu samlet og klar til at blive "primet".

**Maskinen skal være slukket når omskifteren benyttes.**

Sæt omskifteren så den peger ned.

**Omskifter** →



Indstil drejehjul i så den står som på billedet (prime/clean).



Kom Sugeslangen ned i beholderen med maling og start maskinen.

Maskinen vil nu suge malingen op og sende den tilbage i spanden gennem returslangen, så snart der kun kommer Maling ud af den klare plastslange, er maskinen klar til brug.

**Sluk derefter maskinen.**



Indstil omskifteren så den peger lige frem.



Indstil drejhjul så den står på den ønskede spray indstilling, høj for federe maling, lav for tyndere maling. Indstil løbende så det passer til behovet.



Start derefter maskinen. Maskinen vil opbygge tryk og derefter stoppe automatisk, dette vil også ske under brug, baseret på tykkelse af maling og indstilling af drejhjulet.



Du er nu klar til at begynde at male, husk at pilen på dysen skal pege fremad når du sprøjter og at dysen skal være trykket helt ned i pistolen så langt den kan komme.

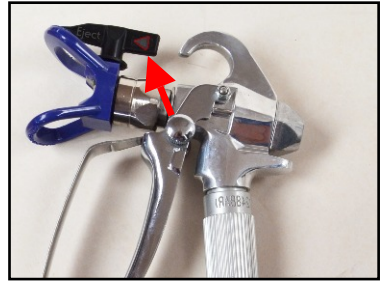

Hvis pistolen maler streger i siderne er dysen for stor til den valgte maling eller malingen er fortyndet for meget.

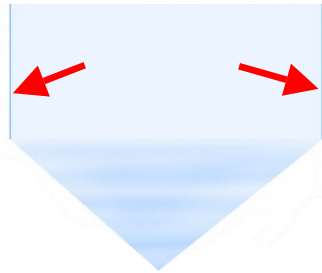

Hvis maskinen kører hele tiden (pumper uden kortvarige stop), overvej da at bruge en mindre dyse.

**(Standard er dysen er 515")**



Ved spray med lak, anbefales en x10 eller x11 dyse.

Vare nr.	TUN/DB	Hul	Vifte	EAN
RP8623-210	1591410	0,25 MM	100-150 MM	5704587010173
RP8623-310	1591411	0,25 MM	150-200 MM	5704587010180
RP8623-315	1591413	0,38 MM	150-200 MM	5704587009566
RP8623-415	1591415	0,38 MM	200-250 MM	5704587009573
RP8623-515	1591416	0,38 MM	250-310 MM	5704587009580
RP8623-517	1591417	0,43 MM	250-310 MM	5704587009559
RP8623-519	1591418	0,48 MM	250-310 MM	5704587009702
RP8623-619	1591420	0,48 MM	310-360 MM	5704587010197

**SPØRG DIN FORHANDLER INDEN DU STARTER, HVIS DU ER I TVIVL.**

# QUICK GUIDE RENSNING

Husk altid at rense din maskine efter endt brug. Her er 2 guides til hvordan du renser sprøjten ved henholdsvis kortvarig (pkt. 1) standsning og efter endt brug (pkt. 2)



## **PKT. 1 Kun ved kortvarig standsning:**

Hvis maskinen skal stå weekenden over eller til næste dag, kan følgende gøres:

Maskinen slukkes og suge slangen sættes i en spand med vand (varmt vand anbefales men er ikke nødvendigt).

Omskifteren stilles nu nedad (tilbageløb) og regulatoren sættes på midterste punkt (spand).

Maskinen startes og skal kun køre i ca. 30 sekunder eller indtil vandet der kommer igennem afløbsslangen er delvist klart.

Herefter slukkes maskinen og kan nu stilles klar til næste dag.

Bemærk: Så længe trykslange og pistol ikke adskilles, er det ikke nødvendigt at rense dette igennem ved dag til dag brug.

## **PKT. 2 Komplet rensning af system:**

Maskinen slukkes og suge slangen sættes i en spand med vand (varmt vand anbefales men er ikke nødvendigt).

Omskifteren stilles først nedad (tilbageløb) for at fjerne tryk i slangen, herefter stilles den igen fremad (spray) og regulatoren sættes på midterste punkt (spand).

Dysen vendes modsat (pil ind mod dig selv) og pistolen aktiveres kortvarigt.

Blokerings knappen på pistolen drejes nu, så grebet er fast aktiveret og pistolen ligger så dysen er rettet ned i spanden.

Maskinen startes og skal nu køre i ca. 2 minutter, eller indtil vandet der kommer igennem er delvist klart.

Herefter følges hele **PKT. 1** for rensning af afløbs slangen.

Slange og pistol kan herefter afmonteres hvis det ønskes og pistolfilter kan efterses.

Systemet er lufttæt så længe slange og pistol ikke er demonteret.

Bemærk: Ved brug af olieholdig maling bør der bruges passende rensmiddel og herefter vand MED sæbe. Maskinen herunder dele på denne, samt pistolen må ALDRIG stå i fortynder, ej heller kun natten over.

Husk, at der ved regelmæssig brug, cirka hver uge bør efterses og renses pistolfilter.

Pistolfilteret sidder i selve håndtaget og der skal bruges 2 stk. 19 mm og 1 stk. 21 mm nøgle til afmontering.

Hvis filteret er trykket sammen bør det skiftes helt, ellers kan dette adskilles og renses.

Hvis der opleves meget tilstopning af dysen, bør der skiftes pistolfilter til korn 100 (som ligger i kassen) i stedet for det korn 60 filter der som standard sidder i pistolen.

Det anbefales IKKE at kører uden filter!

Tilføj syrefri smøremiddel til slangestud på på sprøjten, hvis den ikke bruges i lang tid.

**SPØRG DIN FORHANDLER INDEN DU STARTER, HVIS DU ER I TVIVL!**



## **ADVARSEL vedrørende risiko for brand, elektrisk stød eller skade på personer.**

Når du bruger værktøjet, skal grundlæggende forholdsregler altid følges, herunder følgende:

GEM DISSE ANVISNINGER.

**A) For at mindske risikoen for brand eller eksplosion, elektrisk stød og personskade, læs og forstå alle instruktioner i denne vejledning. Vær fortrolig med kontrollen og korrekt brug af udstyret.**

**B) For at mindske risikoen for brand og eksplosion:**

- 1) Sprøjt ikke brændbare eller brændbare materialer i nærheden af åben ild eller antændelseskilder, såsom cigaretter, motorer og elektrisk udstyr.
- 2) For enheder beregnet til brug med kun vand-baserede materialer, sprøjt ikke eller rengør med brandbare væsker. Brug vandbaserede væsker alene.
- 3) For enheder beregnet til brug med kun vand-baserede eller mineral olie-type materialer med et minimum flammepunkt på 21C ° (69,8 F °) Må ikke sprøjtes på med væsker med et flammepunkt mindre end 21C ° (69,8 F °)
- 4) Maling eller opløsningsmiddel, der sprøjtes gennem udstyret er i stand til at resultere i statisk elektricitet. Statisk elektricitet skaber en risiko for brand eller eksplosion under arbejde med maling eller opløsningsmidlets dampe. Alle dele af spray-systemet, herunder pumpen, slangen, sprøjtehandtag og objekter i og omkring spray området, skal være jordforbundet for at beskytte mod statisk elektricitet og gnister. Brug kun jordforbundne strømforsyninger når airless malingsprøjten bruges.
- 5) Kontroller altid strømforbindelser.
- 6) Tilslut kun til en jordet stikkontakt og brug jordforbundet forlængerledninger. Må ikke bruges med en 3 til 2 adapter.
- 7) Brug ikke en maling eller et opløsningsmiddel indeholdende halogenerede carbonhydrider. Søg på internettet for eksempler på disse typer af materialer.
- 8) Hold spray området godt ventileret.
- 9) Ryg ikke i spray-området.
- 10) Brug ikke lyskontakter, motorer eller lignende gnist producerende produkter i spray-området.
- 11) Hold området rent og fri brændbare materialer.
- 12) Kend indholdet af den maling og de opløsningsmidler, der sprøjtes. Læs alle sikkerhedsdatablade og behold etiketter tilhørende med maling og opløsningsmidlerne. Følg maling og væske producentens sikkerhedsanvisninger.
- 13) Ildslukker udstyr skal være til stede og fungerer.

### **C) For at mindske risikoen for hud injektion.**

- 1) Ret ikke pistolen, eller spray imod personer eller dyr.
- 2) Hold hænder og andre kropsdele væk fra dyseudgangen. Forsøg for eksempel ikke at stoppe lækager med nogen del af kroppen.
- 3) Brug altid dysen korrekt. Sprøjt ikke uden dyse beskytteren på plads.
- 4) Brug kun en dyse angivet af fabrikanten.
- 5) Vær forsigtig ved rengøring og skift af dyse. I tilfælde af, at dysen tilstoppes, under sprøjtning, skal du følge anvisninger for at slukke apparatet og aflastning, før du fjerner mundstykket at rengører.
- 6) Når enheden ikke er i brug, skal du slukke den og lette trykket i overensstemmelse med anvisningerne.
- 7) Højtryks spray er i stand til at injicere giftstoffer i kroppen og forårsage alvorlig personskade. I tilfælde af at injektionen sker, søg lægehjælp omgående.
- 8) Kontroller slange og dele for tegn på skader. Udskift og beskadigede slanger og dele.
- 9) Dette system er i stand til eller producerer 20.7Mpa. Anvend kun reservedele eller tilbehør, som er specificeret af fabrikanten og som er godkendt et minimum af 22.8Mpa.
- 10) Aktiver altid pistolen for at trykudløse, når der ikke sprøjtes.
- 11) Kontroller, at alle tilslutninger er spændt tilstrækkeligt, før du betjener enheden.
- 12) Lær hvordan man stopper enheden og udløser tryk hurtigt. Vær generelt grundigt bekendt med kontrollen.

### **D) For at mindske risikoen for skader.**

- 1) Brug altid passende handsker, øjenbeskyttelse, og en rentluftmaske eller maske, når der males.
- 2) Undlad at betjene eller spray i nærheden af børn. Hold børn væk fra udstyr på alle tidspunkter.
- 3) Stå altid på et stabilt underlag/støtte. Hold effektivt fodfæste og balance hele tiden.
- 4) Vær opmærksom og se hvad du laver.
- 5) Brug ikke enheden, når du er træt eller under indflydelse af narkotika eller alkohol.
- 6) Undlad at vride eller over-bøje slangen.
- 7) Udsæt ikke slangen for temperaturer eller tryk, der overstiger de af fabrikanten angivne.
- 8) Brug ikke slangen til at trække eller løfte udstyret.
- 9) Max. luftrykket slangen 22.8Mpa, det normale tryk er 20.7Mpa
- 10) Malingen kan være af disse typer: phenol aldehyd maling, nitrylmalings serier, alkydmalings serier, epoxy harpiks maling, oxyderede gummi malings serier, latex maling, vandopløselig maling. Malingen skal stå i skygge og tørt sted.
- 11) Vær opmærksom på eventuelle risici, som materiale/maling der sprøjtes og se markeringer på beholderen eller oplysninger fra producenten af det materiale, der skal sprøjtes, herunder krav til anvendelse af personlige værnemidler.

Følgende advarsler gælder for opsætningen, anvendelsen, grundbrug, vedligeholdelse og reparation af dette udstyr.

### **BRAND OG EKSPLOSION**

Brændbare dampe, såsom opløsningsmiddel og maling røg i arbejdsområdet kan antænde eller eksplodere. For at forhindre brand og eksplosion:

- Brug kun udstyret med god ventilation.
- Fjern alle antændelseskilder, såsom vågeblus, cigaretter, bærbare elektriske lamper og klude med potentielle statisk antændelse.
- Når brandfarlig væske anvendes i eller i nærheden af sprøjten eller til skylning eller rengøring, hold da sprøjten mindst 20 fod (svarende til 6 m) væk fra eksplosive dampe.
- Hold arbejdsområdet fri for snavs, herunder opløsningsmidler, klude og benzin.
- Læs Jordforbindelse vejledningen.
- Hvis der ses eller høres statiske gnister eller du føler et chok, stop da driften med det samme. Brug ikke udstyret, før du har identificeret og løst problemet.
- Hold en ildslukker i arbejdsområdet.

### **FARE FOR STØD**

Forkert jordforbindelse, opsætning, eller brug af systemet kan medføre elektrisk stød.

- Sluk og afbryd strømledningen, før service af udstyr.
- Brug kun stikkontakter med jordforbindelse.
- Brug kun 3-leder forlængerledninger.
- Sørg for jord ben er intakt på sprøjten og forlængerledninger.
- Må ikke udsættes for regn og opbevares indendørs.

### **HUD INJEKTION FARE**

Højtryks-væsker fra pistol, slange utætheder eller bristede komponenter kan gennembore huden. Dette kan ligne bare et snit, men det er en alvorlig skade, som kan resultere i amputation.

Få øjeblikkelig kirurgisk behandling.

- Ret ikke pistol mod nogen eller på nogen del af kroppen.
- Læg ikke din hånd ud over spray dysen.
- Undlad at stoppe eller dække utætheder med din hånd, krop, handske eller klud.
- Udløs tryk når de ikke sprøjtes.
- Følg trykaflastnings proceduren i denne vejledning, når du stopper sprøjtning og før rengøring, kontrol eller service af udstyret.

### **Advarsel mod forbræninger!**

Udstyrets overflader kan blive meget varme under driften. For at undgå alvorlige forbrændinger, må du ikke røre ved de varme dele. Vent, indtil udstyret er helt afkølet

### *FARE VED DELE I BEVÆGELSE*

Bevægelige dele kan klemme eller amputere fingre og andre kropsdele.

- Hold afstand til bevægelige dele.
- Betjen ikke udstyret med dyse beskytter eller dækplader fjernet.
- Trykudstyr kan starte uden varsel.

Følg altid proceduren for trykudløsning i denne vejledning. Afbryd altid først strøm.

### *FARE VED GIFTIGE VÆSKER OG DAMPE*

Giftige væsker eller dampe kan forårsage alvorlig personskade eller død, hvis væsken kommer i øjnene, på huden, indånding eller indtagelse.

- Læs advarslerne og kend de specifikke farer ved væsker du bruger.
- Opbevar farlige væsker i godkendte beholdere og bortskaf det i henhold til gældende retningslinjer.

### *PERSONLIGE VÆRNEMIDLER*

De skal bære passende beskyttelsesudstyr, når De opererer og servicerer udstyret til at beskytte Dem mod alvorlig skade, herunder øjenskader, indånding af giftige dampe, forbrændinger, og høretab. Dette udstyr omfatter, men er ikke begrænset til:

- Øjenbeskyttelse
- Tøj og respirator som anbefalet af væske producent.
- Handsker
- Høreværn

## Tekniske Data

Input Power 650W

Strømbehov  $220 \pm 10\%$  (V)

Spænding / frekvens 50Hz

Arbejde Nuværende 4,0 ~ 7,5 A

Max arbejder preeure 20,5  $\pm$  0.7MPa (3300Psi)

Maksimal levering (lpm) 1,44  $\pm$  10% L / min

Standard Dyse 0,515 "

Slange Maks. tryk / længde 83MPa/7.6m

Vægt 7,5 kg

Temperatur 5 ~ 40<sup>o</sup>

## Brugsvejledning:

### Opsætning

**Vigtigt:** Sørg for, at sprayeren er slukket og taget ud fra strømkilden.

1. Tilslut forsynings slangen til sprøjten.
2. Forbind den anden ende af tilførselsslangen til pistol studsens.  
Brug skruenøgler til at stramme alle tilslutninger forsvarligt.

### HUSK!

1. Hvis udstyret er for nylig blevet brugt, udløs da først trykket med pistolen.
2. Ved hjælp af en blyant eller en lignende genstand, indsæt pakning i bagsiden afstudsens.
3. Sæt nu dysen i pistolen.
4. Drej dysen så pilen peger fremad ( i sprayretningen)

### Operation

#### Sprøjtning

1. Vend spray pistolen i vandret position
2. Vær sikker på at dysen vender fremad, pil frem.
3. Hold pistolen vinkelret til emnet og ca. 350 mm. fra overfladen.  
Bevæg pistolen først, derefter aktiver pistolens udløser greb for at sprøjte et test mønster.
4. Øg langsomt pumpetryk indtil dækningen er ensartet

### Justering af sprayretning

1. Sluk maskinen og udløs trykket i slangen.
2. Løsen dysebeskytterens holdemøtrik.
3. Juster dyse og dysebeskytter til at sprøjte et vandret mønster.
4. Juster dyse og dysebeskytter vertikalt at sprøjte er lodret mønster.

### Spray instruktion

1. Under sprøjtemalning, skal du holde pistolen lodret med overfladen af emnet og holde en konstant sprøjte afstand på 350 ~ 400mm.
2. Flyt pistolen, før du aktiverer aftrækkeren. Husk at flytte pistolen med jævnt tempo, når sprøjtearbejdet udføres. Til sidst, slip aftrækkeren og stop bevægelsen øjeblikkeligt.

### Airless Sprayer rengøringsprocedure

Når dysen er blokeret, drej den 180 grader, ret pistol ned i spanden med maling og tryk på pistolens aftrækker, derefter drej dysen tilbage i position til brug under sprøjtning. Pil frem.

### Daglig Vedligehold

Udstyrets levetid er afhængig af det daglig vedligehold. Følgende punkter skal overholdes:

1. Læs guiden til rensning grundigt.
2. Check de elektriske krav, inden hver arbejdsdag.
3. Udfør grundig rengøring af udstyr og tilbehør efter brug.
4. Rengør suge-røret efter rengøring. I tilfælde af eventuelle skader
5. Tilføj syrefri smøremiddel til slangestudsens (udgangen) på på sprøjten, hvis den ikke bruges i længere tid.

### Generel reparationsinformationer

Brændbare materialer spildt på varme, blottede, motor deke kan forårsage brand eller eksplosion.

For at reducere risikoen for forbrændinger, brand eller eksplosion, anvend da ikke sprøjten med beskyttelses dækslet fjernet.

### **ADVARSEL!**

- Kør ikke sprøjte tør i mere end 20 sekunder. Dette kan beskadige pumpen pakninger.
- Undgå pumpe korrosion og skader fra frost. Efterlad aldrig vand eller vand-base maling i sprøjten, når det ikke er i brug i koldt vejr. Frysning af væsker kan medføre alvorlige skader på sprøjten.

## SERVICE:

Hvis du ønsker at få besigtiget og/eller serviceeret din Voltage Paintmaster skal du henvende dig i den forretning, hvor du har købt maskinen.

Det kan være en god idé at medbringe din købsfaktura.

Service værkstedet i Danmark håndterer alle reklamationer og service sager og tilbyder al slags servicering af Voltage maskiner.

Ved spørgsmål i forbindelse med reklamationer, servicering, reservedele og lignende, besøg evt. [www.dva.dk](http://www.dva.dk) eller kontakt os på telefon: 70 23 42 39

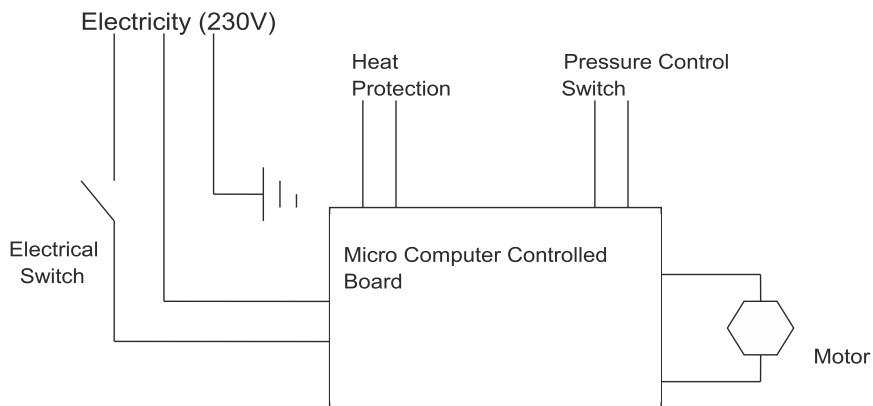

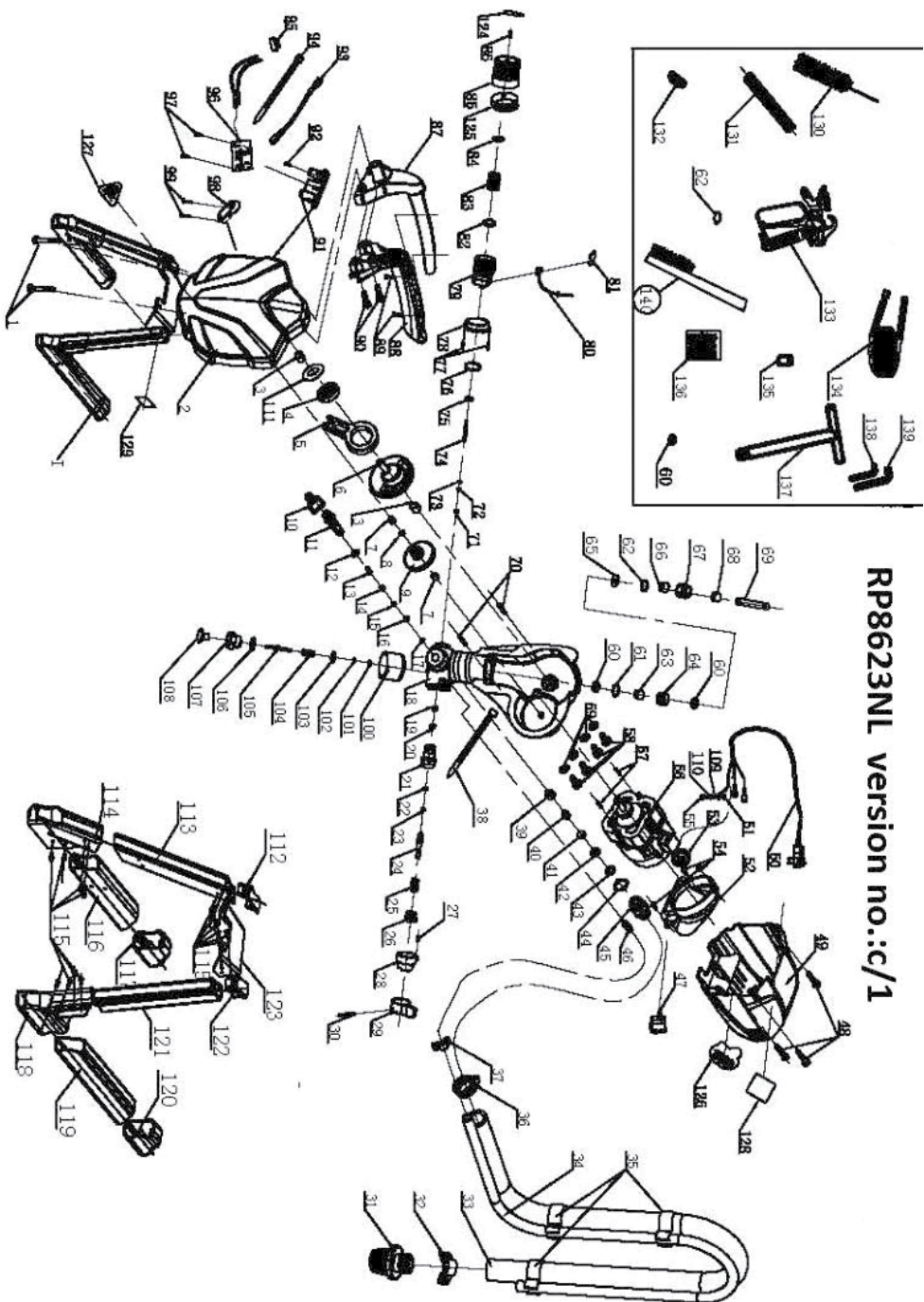

RP8623NL version no.:c/1



## Parts list

No.	Description	Qty.	No.	Description	Qty.	No.	Description	Qty.
1	Hex Bolt M6*20	2	45	Paint Input adaptor	1	89	Hex bolt M4*10	2
2	Pump cover	1	46	Pressure relief plug	1	90	Hex bolt M6*25	2
3	Output Gear bushing	2	47	Power switch	1	91	PCB supporter	1
4	Rolling bearing	1	48	Hex bolt M5*14	3	92	Bolt M4*10	1
5	Output pole	1	49	Housing	1	93	Wire connector	1
6	Gear	1	50	Power plug	1	94	Nylon Cable tie	1
7	Gear bushing	2	51	Locking ring	1	95	Safety cover	1
8	Gear washer	1	52	Exhust tube	1	96	PCB Assembly	1
9	Output gear	1	53	Wire Fastening seat	1	97	Tapping screw	2
10	Screw	1	54	Screw 3.5*10	3	98	Power cord fixer	1
11	Paint outlet	1	55	Bolt M4*10	1	99	Bolt M4*20	2
12	O-ring 10*8	1	56	Motor assembly	1	100	Shield	1
13	Output spring	1	57	Pin 3*12	2	101	O-ring 2.4*1.8	1
14	Mandrel	1	58	Hex bolt M5*14	4	102	Stopper	1
15	Steel ball 6.4	1	59	Spring washer 5	4	103	Copper gasket	1
16	Seal seat	1	60	Joint stopper	2	104	Touch control spring	1
17	Output washer	1	61	O-ring	1	105	Touch control pole	1
18	Pump	1	62	O-ring 22.5*1.8	1	106	O-ring 10*1.5	1
19	Plastic washer	1	63	Stopper sleeve	1	107	Touch control seat	1
20	Screw seat insert	1	64	Position washer	1	108	Touch control stem	1
21	Pressure relief valve seat	1	65	Copper washer	1	109	Flat washer 4	1
22	O-ring 5*1.8	1	66	Felt	1	110	Spring washer 4	1
23	Ring	1	67	Connector seat	1	111	Pole stopper	1
24	Pressure relief valve pole	1	68	Copper guide bushing	1	112	Pump frame assembly	1
25	Spring	1	69	Connector	1	130	Bush	1
26	Spring seat	1	70	Pin 5*12	2	131	Filter	1
27	Pin 3*8	1	71	Lock sleeve	1	132	Rubber stopper	1
28	Switch seat	1	72	White seal	1	133	Airless paint sprayer	1
29	Switch knob	1	73	sealing washer	1	134	Paint hose 7.6m	1
30	Pin 2.5*25	1	74	Pressure control pin	1	135	Socket 22mm	1
31	Filtrate seat assembly	1	75	O-ring 8.8*1.9	1	136	Manual	1
32	Inlet pipe lock ring	1	76	O-ring 27*2.4	1	137	Wrench	1
33	Suction tube	1	77	Hex bolt M3*10	2	138	Hex wrench 4mm	1
34	Priming tube	1	78	Pressure seal cover	1	139	Hex wrench 5mm	1
35	Clip	1	79	Micro switch	1	140	Bush	1
36	Large clamp	1	80	Micro switch cover	1			
37	Small clamp	1	81	Pressure control switch	1			
38	Nylon cable tie	1	82	Switch cover	1			
39	Inlet spring holder	1	83	Pressure adjusting spring	1			
40	Input spring	1	84	Spring pusher	1			
41	Steel ball 12.7	1	85	Pressure knob	1			
42	Input seal	1	86	Pressure control bolt	1			
43	Input washer	1	87	Up handle	1			
44	O-ring 17*1.8	1	88	Below handle	1			

© Important safety instructions.....	2~3
© Technical Data.....	3
© Warning .....	4~6
© Installation.....	7~9
© Pressure Relief Procedure.....	9
© Operation instruction.....	10~13
© Airless Sprayer Cleaning Procedure.....	14~16
© Long Term storage.....	17
© Grounding and electric requirements.....	18~19
© Daily Maintain.....	19
© General Repair Information.....	20
© Troubleshooting.....	21
© Parts List.....	22-27
© Airless Sprayer Electrical Installation Drawing.....	28

## ✘ IMPORTANT SAFETY INSTRUCTIONS

### INSTRUCTIONS PERTAINING TO A RISK OF FIRE, ELECTRIC SHOCK, OR INJURY TO PERSONS

**WARNING** – When using tools, basic precautions should always be followed, including the following:

a) **SAVE THESE INSTRUCTIONS**-To reduce the risks of fire or explosion, electrical shock and injury to persons, read and understand all instructions included in this manual. Be familiar with the controls and the proper usage of the equipment.

b) **WARNING-To reduce the risk of fire of explosion:**

- 1) Do not spray flammable or combustible materials near an open flame or sources of ignition such as cigarettes, motors, and electrical equipment.
- 2) For units intended for use with only water-based materials-Do not spray or clean with flammable liquids. For use with water-based liquids only.
- 3) For units intended for use with only water-based or mineral spirit-type materials with a minimum flash point of 21C°(69.8 F°) Do not spray on clean with liquids having a flash point less than 21C°(69.8 F°)
- 4) Paint or solvent flowing through the equipment is able to result in static electricity. Static electricity creates a risk of fire or explosion in the presence of paint or solvent fumes. All parts of the spray system, including the pump, hose assemble, spray gun, and objects in and around the spray area shall be properly grounded to protect against static discharge and sparks. Use only conductive or grounded high-pressure airless paint sprayer hoses specified by the manufacturer.
- 5) Verify that all containers and collection systems are **grounded** to prevent static discharge.
- 6) **Connect to a grounded outlet and use grounded extension cords. Do not use a 3 to 2 adapter.**
- 7) Do not use a paint or a solvent containing halogenated hydrocarbons. See operating instructions for examples of these types of materials.
- 8) Keep spray area well ventilated. Keep a good supply of fresh air moving through the area. Keep pump assembly in a well ventilated area. Do not spray pump assembly.
- 9) Do not smoke in the spray area.
- 10) Do not operate light switches, engines, or similar spark producing products in the spray area.
- 11) Keep area clean and free of paint or solvent containers, rags, and other flammable materials.
- 12) Know the contents of the paints and solvents being sprayed. Read all Material safety Data Sheets (MSDS) and container labels provided with the paints and solvents. Follow the paint and solvent manufacturer's safety instructions.
- 13) Fire extinguisher equipment shall be present and working.

c) **WARNING-To reduce the risk of skin injection.**

- 1) Do not aim the gun at, or spray any person or animal.
- 2) Keep hands and other body parts away from the discharge. For example, do not try to stop leaks with any part of the body.
- 3) Always use the nozzle tip guard. Do not spray without nozzle tip guard in place.
- 4) Only use a nozzle tip specified by the manufacturer.

- 5) Use caution when cleaning and changing nozzle tips. In the case where the nozzle tip clogs while spraying, follow the manufacturer's instructions for turning off the unit and relieving the pressure before removing the nozzle tip to clean.
- 6) Do not leave the unit energized or under pressure while unattended. When the unit is not in use, turn off the unit and relieve the pressure in accordance with the manufacturer's instructions.
- 7) High-pressure spray is able to inject toxins into the body and cause serious bodily injury. In the event that injection occurs, seek medical attention immediately.
- 8) Check hose and parts for signs of damage. Replace and damaged hoses of parts.
- 9) This system is capable of producing 20.7Mpa. Only use replacement parts or accessories that are specified by the manufacturer and that are rated a minimum of 22.8Mpa.
- 10) Always engage the trigger lock when not spraying. Verify the trigger lock is functioning properly.
- 11) Verify that all connections are secure before operating the unit.
- 12) Know how to stop the unit and bleed pressure quickly. Be thoroughly familiar with the controls.

**d) WARNING-To reduce the risk of injury.**

- 1) Always wear appropriate gloves, eye protection, and a respirator or mask when painting.
- 2) Do not operate or spray near children. Keep children away from equipment at all times.
- 3) Do not overreach or stand on an unstable support. Keep effective footing and balance at all times.
- 4) Stay alert and watch what you are doing.
- 5) Do not operate the unit when fatigued or under the influence of drugs or alcohol.
- 6) Do not kink or over-bend the hose.
- 7) Do not expose the hose to temperatures or to pressures in excess of those specified by the manufacturer.
- 8) Do not use the hose as a strength member to pull or lift the equipment.
- 9) The Max. pressure of the air hose is 22.8Mpa, the normal pressure is 20.7Mpa
- 10) The paint can be compatible: phenol aldehyde paint series, nitril paint series, alkyd paint series, epoxy resin paint series, oxidized rubber paint series, latex paint series, water soluble paint series. The paint should be put in shade and dry place.
- 11) Be aware of any hazards presented by the material being sprayed and consult the markings on the container or information supplied by the manufacturer of the material to be sprayed, including requirements for the use of personal protective equipment.
- 12) Do not spray any material there the hazard is not know.



## Technical Data

TYPE:	RP8623
Power requirements	230±10%Vac, 50±1Hz
Input power	650-750W
Rated current	2.0~4.5A
Maximum working pressure	3000PSI
Sound pressure level:	89 db
Vibration value:	0.715 m/s <sup>2</sup>
Maximum delivery gpm (lpm)	1.44
Working environment temperature requirement:	5℃~40℃
Working environment humidity requirement:	30%~95%
Standard nozzle	517
Transportation and storage temperature requirement:	25℃~55℃
Paint hose:	7.6m
Paint outlet connector:	1/4-18-NPSM
Dimensions Weight	7.5kg



## Warning

The following warnings are for the setup, use, grounding, maintenance and repair of this equipment. The exclamation point symbol alerts you to a general warning and the hazard symbol refers to procedure-specific risks. Refer back to these warnings. Additional, product-specific warnings may be found throughout the body of this manual where applicable.

	<p><b>FIRE AND EXPLOSION HAZARD</b></p> <p>Flammable fumes, such as solvent and paint fumes, in work area can ignite or explode. To help prevent fire and explosion:</p> <ul style="list-style-type: none"><li>• Use equipment only in well ventilated area.</li><li>• Eliminate all ignition sources; such as pilot lights, cigarettes, portable electric lamps, and plastic drop cloths (potential static arc).</li><li>• Sprayer generates sparks. When flammable liquid is used in or near the sprayer or for flushing or cleaning, keep sprayer at least 20 feet (6 m) away from explosive vapors.</li><li>• Keep work area free of debris, including solvent, rags and gasoline.</li><li>• Do not plug or unplug power cords or turn lights on or off when flammable fumes are present.</li><li>• <b>Ground equipment and conductive objects in work area. Read Grounding instructions.</b></li><li>• If there is static sparking or you feel a shock, <b>stop operation immediately.</b> Do not use equipment until you identify and correct the problem.</li><li>• Keep a working fire extinguisher in the work area.</li></ul>
	<p><b>ELECTRIC SHOCK HAZARD</b></p> <p>Improper grounding, setup, or usage of the system can cause electric shock.</p> <ul style="list-style-type: none"><li>• Turn off and disconnect power cord before servicing equipment.</li><li>• <b>Use only grounded electrical outlets.</b></li><li>• Use only 3-wire extension cords.</li><li>• Ensure ground prongs are intact on sprayer and extension cords.</li><li>• Do not expose to rain. Store indoors.</li></ul>
	<p><b>SKIN INJECTION HAZARD</b></p> <p>High-pressure fluid from gun, hose leaks, or ruptured components will pierce skin. This may look like just a cut, but it is a serious injury that can result in amputation. <b>Get immediate surgical treatment.</b></p> <ul style="list-style-type: none"><li>• Do not point gun at anyone or at any part of the body.</li><li>• Do not put your hand over the spray tip.</li><li>• Do not stop or deflect leaks with your hand, body, glove, or rag.</li><li>• Engage trigger lock when not spraying.</li><li>• Follow <b>Pressure Relief Procedure</b> in this manual, when you stop spraying and before cleaning, checking, or servicing equipment.</li></ul>



# WARNING



## EQUIPMENT MISUSE HAZARD

Misuse can cause death or serious injury.

- Do not exceed the maximum working pressure or temperature rating of the lowest rated system component. Read **Technical Data** in all equipment manuals.
- Use fluids and solvents that are compatible with equipment wetted parts. Read **Technical Data** in all equipment manuals. Read fluid and solvent manufacturer's warnings. For complete information about your material, request MSDS from distributor or retailer.
- Check equipment daily. Repair or replace worn or damaged parts immediately with manufactory replacement parts only.
- Do not alter or modify equipment.
- Use equipment only for its intended purpose. Call your distributor for information.
- Route hoses and cables away from traffic areas, sharp edges, moving parts, and hot surfaces.
- Do not kink or over bend hoses or use hoses to pull equipment.
- Comply with all applicable safety regulations.
- Keep children and animals away from work area.
- Do not operate the equipment when fatigued or under the influence of drugs or alcohol.



## PRESSURIZED ALUMINUM PARTS HAZARD

Do not use 1, 1, 1-trichloroethane, ethylene chloride, other halogenated hydrocarbon solvents or fluids containing such solvents in pressurized aluminum equipment.

Such use can cause serious chemical. Reaction and equipment rupture, and result in death, serious injury, and property damage.



## BURN HAZARD

Equipment surfaces can become very hot during operation. To avoid severe burns, do not touch hot equipment. Wait until equipment has cooled completely.



## MOVING PARTS HAZARD

Moving parts can pinch or amputate fingers and other body parts.

- Keep clear of moving parts.
- Do not operate equipment with protective guards or covers removed.
- Pressurized equipment can start without warning. Before checking, moving, or servicing equipment, follow the **Pressure Relief Procedure** in this manual. Disconnect power or air supply.



### **TOXIC FLUID OR FUMES HAZARD**

Toxic fluids or fumes can cause serious injury or death if splashed in the eyes or on skin, inhaled, or swallowed.

- Read warnings to know the specific hazards of the fluids you are using.
- Store hazardous fluid in approved containers, and dispose of it according to applicable guidelines.



### **PERSONAL PROTECTIVE EQUIPMENT**

You must wear appropriate protective equipment when operating, servicing, or when in the operating area of the equipment to help protect you from serious injury, including eye injury, inhalation of toxic fumes, burns, and hearing loss. This equipment includes but is not limited to:

- Protective eye wear
- Clothing and respirator as recommended by the fluid and solvent manufacturer
- Gloves
- Hearing protection

## **Special Focus**

- A) Forbidden use of machines which are not designed for potentially explosive atmospheres
- B) Use of electrostatic atomizing and spraying equipment with machines not specially designed for this equipment, because it may result in serious hazards for the operators
- C) Hazards resulting from contact with and/or breathing of toxic materials, gases, mists and vapours which may be created by operation of the machine. Such warnings shall also include such regarding the use of personal protective equipment and reminding the user to be aware of the recommendations of the coating material manufacturer;
- D) Surface temperatures of any part of the machine, reachable during normal operation, maintenance and servicing but not normally in contact with the human body, which can exceed 48°C or be less than 0°C.
- E) Pressured coating material and /or compressed air not to be directed towards persons or animals;
- F) Relating to training for the safe operation, adjustment, cleaning and maintenance of the machine;
- G) Regarding any special earthing measures;
- H) Stating that a list of the materials used in the construction of the machine will be made available on request to validate the compatibility with the coating materials being used;
- I) Regarding the requirements of using the machine only in a well ventilated area with regards to health, fire and explosion risks;
- J) Regarding the visually inspection for damage on hoses which may be subjected to friction
- K) Requirements for environmental protection to be observed
- L) Reduce the quantity of coating and/or auxiliary materials at workplaces to a minimum

## **Special Attention:**

- a) Maximum allowable pressure for the coating material..... 20.7 Mpa (3000psi)
- b) Typical coating material flow rate for sample conditions: 1.1 or 1.44L/Min
- c) Type and use of any safety devices in the machine:
  1. Temperature control device
  2. Maximum pressure control device
  3. Maximum electrical current control device
  4. Creepage protect control device
  5. Hand-hurt protect device

# INSTALLATION:

**RETURNS NOT ACCEPTED & WARRANTY VOID  
if Sprayer is not properly cleaned immediately after every use.**

**Clean Sprayer immediately to prevent permanent damage.**

## Before You Begin

Familiarize yourself with the Paint Sprayer and its functions.

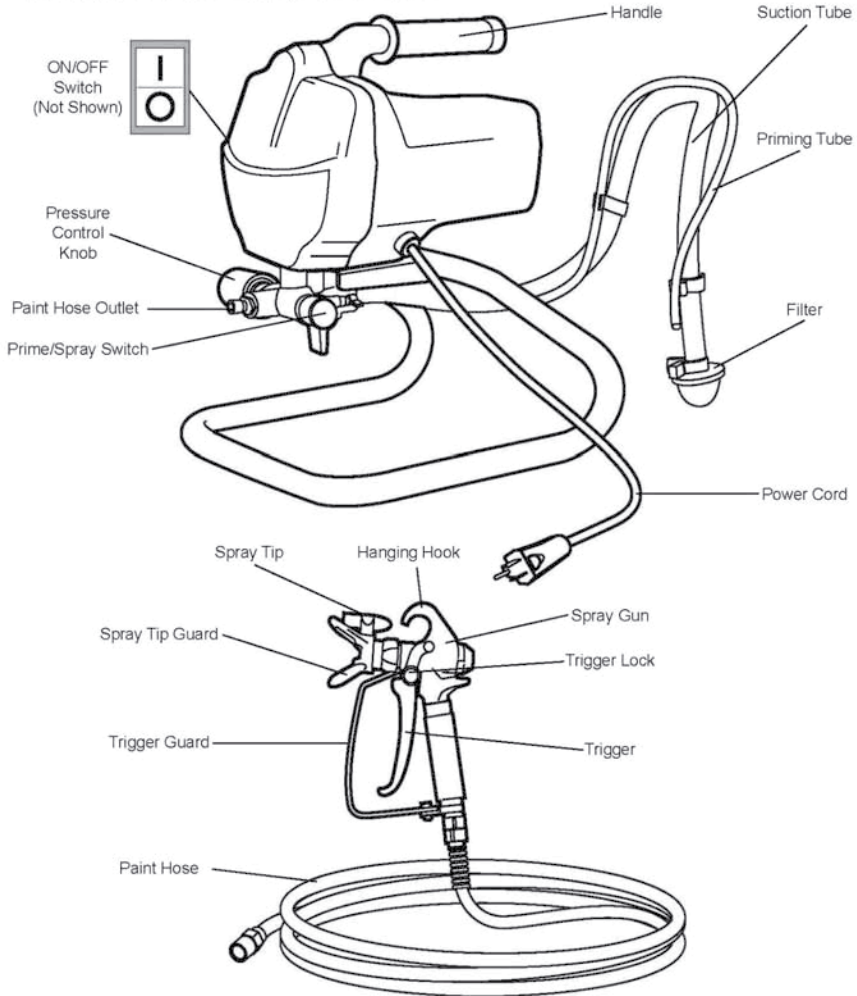

For technical questions, please contact to where you buy this product.

**RETURNS NOT ACCEPTED & WARRANTY VOID**  
 if Sprayer is not properly cleaned immediately after every use.

**Clean Sprayer immediately to prevent permanent damage.**

### Prime/Spray Switch

This switch toggles the unit between priming mode and spraying mode.

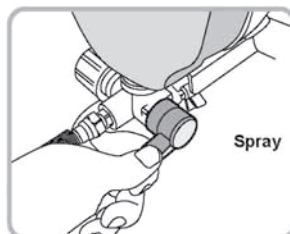
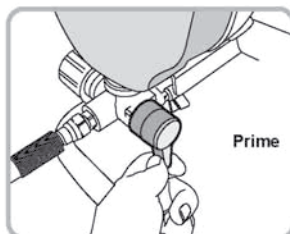

### Trigger Lock

When engaged, this mechanism prevents the trigger from being pulled accidentally such as if the gun is dropped.

**Lock whenever not in use.**

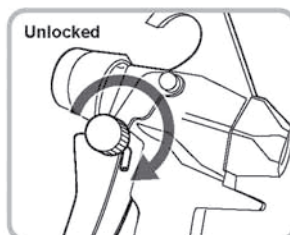
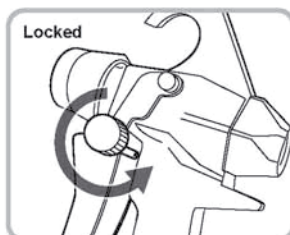

### Nozzle

The nozzle is reversible and removable to make cleaning and unclogging easier.

Turn to Spray (▶) position to use the spray gun.

Turn to Clean (Eject) position to clean the nozzle.

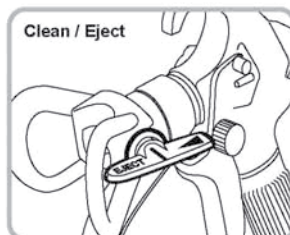
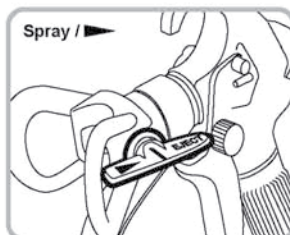

### Pressure Control Knob

The Pressure Control Knob can be adjusted for High Pressure Spraying, Low Pressure Spraying, Priming/Cleaning, or Rolling. Align the Pressure Control Knob with indicator on the Sprayer Housing to set the function.

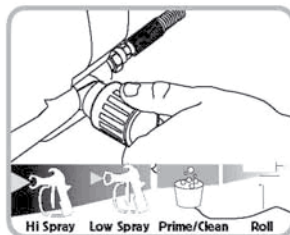

Low Pressure Spray

Rolling



High Pressure Spray

Prime/Clean



**RETURNS NOT ACCEPTED & WARRANTY VOID  
if Sprayer is not properly cleaned immediately after every use.**

**Clean Sprayer immediately to prevent permanent damage.**

### Setup

**Note:** Remove or cover objects that you want to protect from overspray (paint mist).

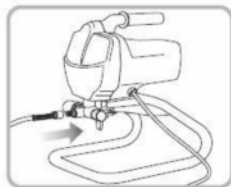

1. Attach Paint Hose to Paint Hose Outlet and tighten with wrench.

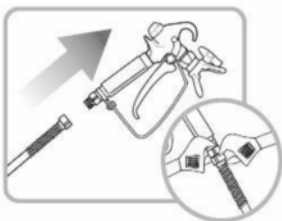

2. Attach Paint Hose to Paint Gun and tighten with two wrenches.

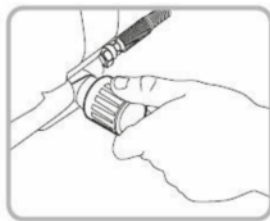

3. Turn Pressure Control Knob to Low Pressure Spray setting.

### To Relieve Sprayer Pressure



1. Turn Power Switch off and unplug unit from outlet.



4. Turn Trigger Lock Knob to Locking position.

**Note:** Always set to Prime mode between uses.

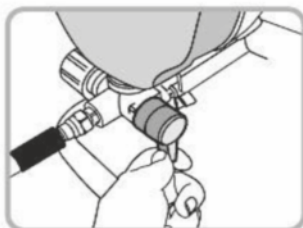

2. Switch Prime/Spray switch to Prime mode.

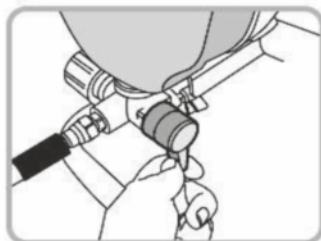

3. Point gun into paint pail and activate Sprayer Trigger to relieve pressure.

# Operating Instructions

## BEFORE STARTING

**(1)CHECK** all fittings and connections in the pump system, hose, and gun to ensure that they are tight.

**CHECK** to ensure that there is a spray tip in the gun, and that the tip is the correct size for the coating you are to spray. (There are various tips available, for each type of coating or configuration.)

**(2) MAKE SURE** the power source is securely grounded and match the motor rating of your sprayer.

**(3) New spray:** Oil is used by the factory for testing and protection. It is necessary to flush unit before spraying. Clean the pump with warm soapy water, Make sure the hydraulic oil in the pump is clean and sufficient in volume then begin the following procedure

1. Remove spray tip from gun
2. Put the input hose and pressure relief tube into the bucket with some water,
3. Turn on the motor and push the pressure valve upright. In a few seconds, water will begin to flow up through the tube and flow out from outlet valve, tighten the outlet valve deasil, then tighten the pressure valve deasil.
4. When the pressure reaches up to around 207bar, check if there is any leakage on the outlet hose, if it's leak, Please check. Don't stop or deflect leaks with your hand, body, glove or rag.
5. If doesn't leak, open the spray gun and have a testing spray. Clean the oil in pump. Change the soapy water and use clean water when the spray is clean.
6. Turn off power, Continue to spray till no water out.
7. Unlock trigger lock. Put the pressure valve upright, till no soapy water in pump.

## Pressure release procedure

Whenever instructed to relieve pressure, Stop spraying, Check or service equipment or install or clean spray tip.

1. Engage trigger safety lock on gun. Turn Off power and turn sprayer pressure control to lowest pressure setting.
2. Hold gun against side of flushing pail. Trigger gun into pail to relieve pressure.
3. Turn off pump and release fluid pressure by turning the pressure relief prime valve located on the side of the pump down.

**RETURNS NOT ACCEPTED & WARRANTY VOID**  
if Sprayer is not properly cleaned immediately after every use.

**Clean Sprayer immediately to prevent permanent damage.**

## Priming Spray Gun

This procedure is used for first time operation and also to flush storage fluids out of the Sprayer.

### Priming Water-Based vs. Oil-Based Paints

#### Oil-based Paint:

Flush with mineral spirits followed by warm clean water.

#### **WARNING! TO PREVENT FIRE:**

When using mineral spirits, ground gun by holding it against a metal container while flushing.

#### Water-based (Latex) Paint:

Flush with warm clean water.

### Priming and Startup Steps

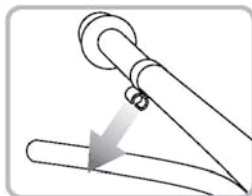

1. Separate smaller Priming Tube from Suction Tube.

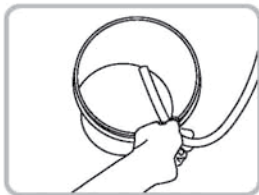

2. Place Priming Tube in waste bucket.

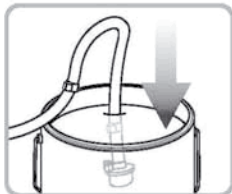

3. Submerge Suction Tube in water or flushing solvent.

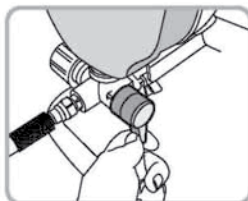

4. Turn Prime/Spray switch to Prime mode.

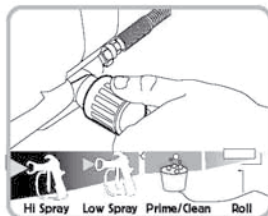

5. Adjust Pressure Control Knob to Prime/Clean setting.



6. Plug in Sprayer and turn on power.



7. Sprayer will start pumping and water or flushing solvent as well as air bubbles will be purged from system. Let fluids discharge from Priming Tube into waste bucket for 30 to 60 seconds then switch Power to Off.

**RETURNS NOT ACCEPTED & WARRANTY VOID  
if Sprayer is not properly cleaned immediately after every use.**

**Clean Sprayer immediately to prevent permanent damage.**

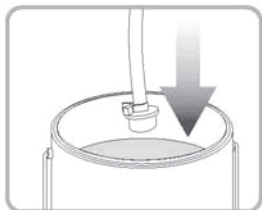

8. Remove Suction Tube from water or flushing solvent and submerge in paint pail.

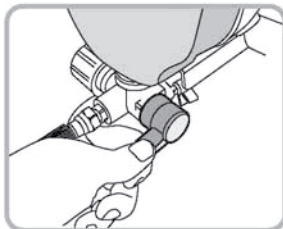

11. Turn Spray/Prime Switch to Spray mode and continue to spray into waste bucket.

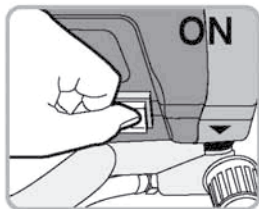

9. Switch Power to On.

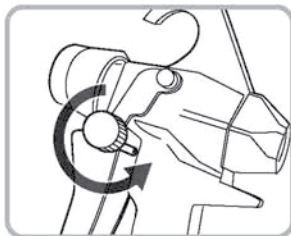

12. Stop spraying and activate trigger lock.



10. Paint should work itself from Suction Tube to Sprayer to Priming Tube until paint discharges from Return Tube. Point gun into waste bucket and pull trigger.

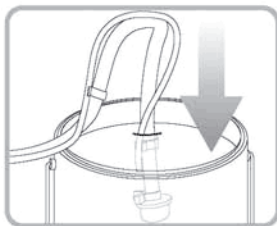

13. Remove the Priming Tube from the waste bucket and clip to Suction Tube and submerge in paint pail.

14. If the motor stops, the pump and tubes are primed. If it does not stop, repeat priming steps.

15. Start Painting.

**RETURNS NOT ACCEPTED & WARRANTY VOID  
if Sprayer is not properly cleaned immediately after every use.**

**Clean Sprayer immediately to prevent permanent damage.**

## Painting

Before painting, ensure the Sprayer has been primed (see Priming and Startup steps) and verify that Nozzle Tip is aligned properly.

**Note:** Remove or cover objects that you want to protect from overspray and paint mist.

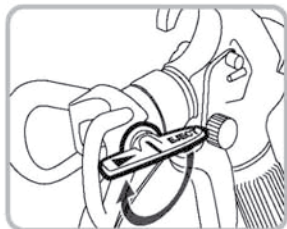

1. Once primed, adjust nozzle to Spray setting.

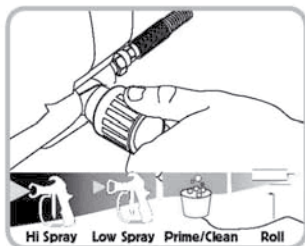

2. Start spraying at the lowest setting on the Pressure Control Knob and increase pressure as needed by turning clockwise to create a good spray pattern.

## Painting Techniques

Before painting, ensure the Sprayer has been primed (see Priming and Startup steps) and verify that Nozzle Tip is aligned properly. Keep the gun approximately 1 foot from the surface.

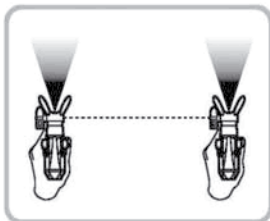

1. Keep gun straight and move arm across at a steady rate while staying one foot from the surface.

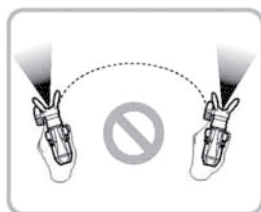

2. Do not fan the gun or paint will be uneven.

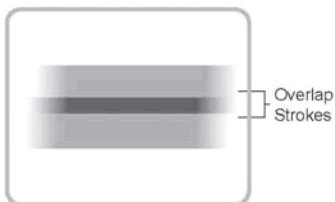

3. Overlap strokes by half, always aim stroke at bottom edge of last stroke.

**RETURNS NOT ACCEPTED & WARRANTY VOID  
if Sprayer is not properly cleaned immediately after every use.**

**Clean Sprayer immediately to prevent permanent damage.**

### Clearing Spray Tip

Occasionally, the Spray Gun Tip will become clogged with paint. Follow these instructions to clear Spray Gun Tip.

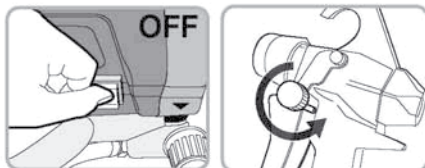

1. Switch power off and set Trigger Lock.

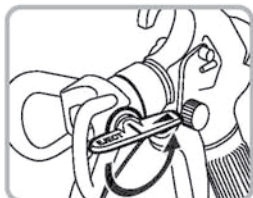

2. Adjust nozzle to clean setting.

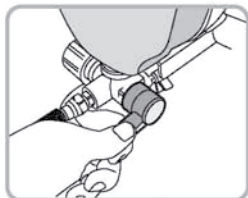

3. Turn Spray/Prime Switch to Spray mode.



4. Turn power on.



5. Unlock Trigger.

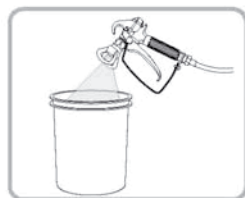

6. Spray into waste bucket until clog clears.

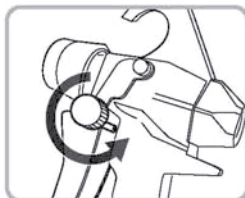

7. Release Trigger and engage Trigger Lock.

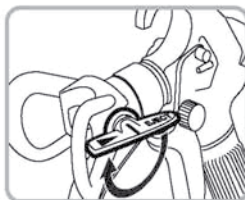

8. Adjust nozzle to Spray mode.

**RETURNS NOT ACCEPTED & WARRANTY VOID  
if Sprayer is not properly cleaned immediately after every use.**

**Clean Sprayer immediately to prevent permanent damage.**

## Cleaning



1. Relieve pressure and drain paint from Tubes.

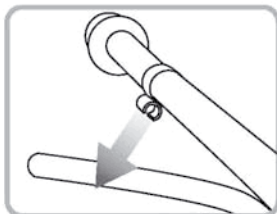

2. Separate tubes.

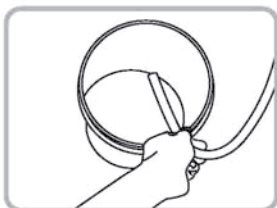

3. Place Priming Tube in empty waste bucket.

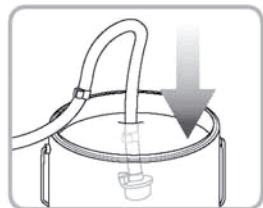

4. Submerge Suction Tube in water or flushing fluid.

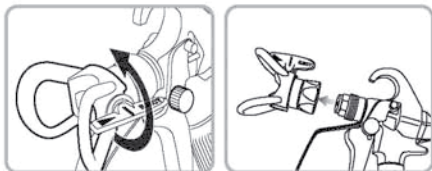

5. Unthread Spray Tip and remove.

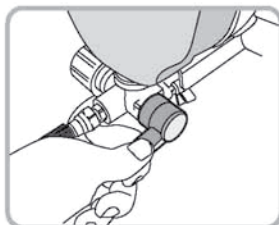

6. Turn to Spray mode.

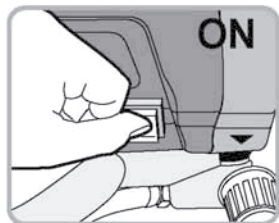

7. Switch power to on.



8. Spray paint into paint pail.

**RETURNS NOT ACCEPTED & WARRANTY VOID  
if Sprayer is not properly cleaned immediately after every use.**

**Clean Sprayer immediately to prevent permanent damage.**



9. Change to waste bucket as paint thins.



13. Remove trigger guard from housing.

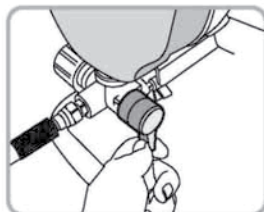

10. Turn to Prime mode.



14. Unscrew nut.



11. Continue to flush until clear.

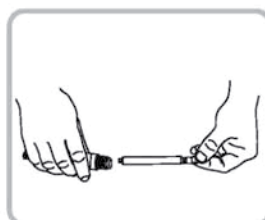

15. Remove filter.



12. Release trigger, turn power off and relieve pressure.

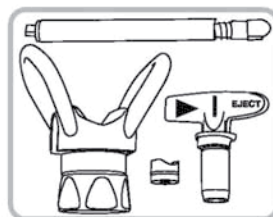

16. Clean all parts in warm, soapy water or flushing fluid with a bristled brush.



**RETURNS NOT ACCEPTED & WARRANTY VOID**  
if Sprayer is not properly cleaned immediately after every use.

**Clean Sprayer immediately to prevent permanent damage.**

### Long Term Storage

When cleaning for long term storage (more than 48 hours).

It is very important that the Paint Sprayer is not stored with any water or water-based material left in the Pump, Hose, Tubes, or Spray Gun. This will corrode the product.

**IMPORTANT:** Clean the Sprayer before storage. See "Cleaning" on pages 16-17.

1. Remove paint hose if not already removed.

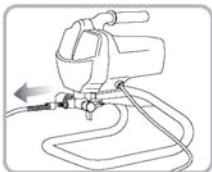

2. Turn the unit over and loosen the Clamps from both Tubes, then disconnect Tubes from the Pump Body.

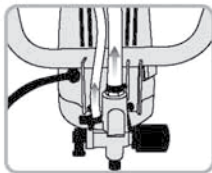

3. Add one ounce of light household oil or a pump storage product into each inlet.

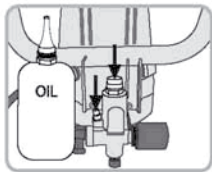

4. Turn Prime/Spray switch to Spray.

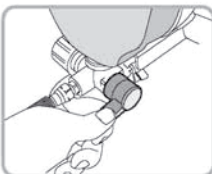

5. Turn Pressure Control Knob to Low/Spray.



6. Hold a rag over the paint hose outlet.



7. Switch Power to ON for five seconds, then turn the power OFF.

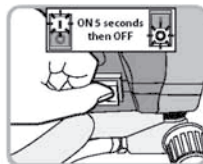

8. Turn Prime/Spray switch to Prime, this will keep storage fluids in sprayer.

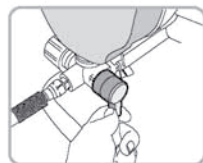

9. Replace the Tubes and secure with the Clamps.

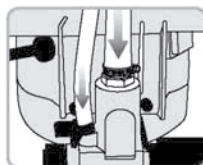

10. Wipe the sprayer with a clean cloth. Store in a clean dry location out of reach of children.

# Grounding and Electric Requirements



## Grounding Instructions

**This product must be grounded.** In the event of an electrical short circuit, grounding reduces the risk of electric shock by providing an escape wire for the electric current. This product is equipped with a cord having a grounding wire with an appropriate grounding plug. The plug must be plugged into an outlet that is properly installed and grounded in accordance with all local codes and ordinances.

Improper installation of the grounding plug can result in a risk of electric shock.

If repair or replacement of the cord or plug is necessary, do not connect the green grounding wire to either flat blade terminal. The wire with insulation having a green outer surface with or without yellow stripes is the grounding wire and must be connected to the grounding pin. Check with a qualified electrician or serviceman if the grounding instructions are not completely understood, or if you are in doubt as to whether the product is properly grounded. Do not modify the plug provided. If the plug will not fit the outlet, have the proper outlet installed by a qualified electrician.

**The sprayer cord includes** a grounding wire with an appropriate grounding contact.

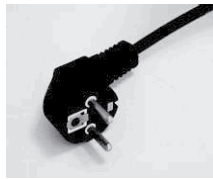

**The sprayer requires for type 470:**  
220-240Vac, 50Hz, 11A, 1 phase,  
circuit with a grounding receptacle.

**Never use an outlet that is not grounded or an adapter.**



**Do not use the sprayer if the electrical cord has a damaged ground contact. Only use an extension cord with an undamaged ground contact.**



Smaller gauge or longer extension cords may reduce sprayer performance.

**Spray gun:** ground through connection to a properly grounded fluid hose and pump.

**Fluid supply container:** follow local code.

**Solvent and Oil-based fluids:** follow local code. Use only conductive metal pails placed on a grounded surface such as concrete. Do not place the pail on a nonconductive surface such as paper or cardboard, which interrupts grounding continuity.

**Grounding the metal pail:** Connect a ground wire to the pail by clamping one end to pail and other end to ground such as a water pipe.

**To maintain grounding continuity when flushing or relieving pressure:** hold metal part of the spray gun firmly to the side of a grounded metal pail, then trigger the gun.



## Electrical bonding



A hose, hose assembly, and spray gun assembly shall be constructed to provide electrical bonding to dissipate static electricity from the tip of the Spray gun through the spray gun assembly and the couplings at the ends of the hose to the pump assembly. The spray gun assembly shall also provide an external means to dissipate static electricity during the cleaning process when spraying into a metal container.

### Construction

Black hose is constructed of an extruded, seamless thermoplastic inner tube, chemically bonded to multi-layers of high tensile synthetic resistant polyurethane cover. A static drain element of flexible, electrically conductive material is located between the braid layers.

## FEATURES

- Polyurethane cover permits greater flexibility and tighter bends
- Resistant to flex fatigue
- Dissipates static charge
- Will not swell or degrade in contact with most paint chemicals, oils and most other solvents
- Light weight- approximately half that of comparable rubber or wire hose
- O.D smaller than comparable rubber hose without reducing the I.D., pressure rating, or fluid-carrying capacity
- Highly abrasion resistant
- Extremely durable

## Daily Maintain

Equipment lifetime is rely on daily maintain. The following respects should be obeyed:

1. Read the Manual carefully before first using.
2. Check the electrical requirement before each working.
3. Thorough cleaning equipment and the accessories after using.
4. Coil the tube after cleaning, in case of any damage.
5. Add some lubricant if long time not use.

# General Repair Information



Flammable materials spilled on hot, bare, motor could cause fire or explosion. To reduce risk of burns, fire or explosion, do not operate sprayer with cover removed.

- Keep all screws, nuts, washers, gaskets, and electrical fittings removed during repair procedures. These parts usually are not provided with replacement kits.
- Test repairs after problems are corrected.
- If sprayer does not operate properly, review repair procedure to verify you did it correctly. See **Troubleshooting**, page 8.
- Overspray may build up in the air passages. Remove any overspray and residue from air passages and openings in the enclosures whenever you service sprayer.
- Do not operate the sprayer without the motor shroud in place. Replace if damaged. Motor shroud directs cooling air around motor to prevent overheating and insulates the control board from accidental electric shock.



To reduce risk of serious injury, including electric shock:

- Do not touch moving or electric parts with fingers or tools while testing repair.
- Unplug sprayer when power is not required for testing.
- Install all covers, gaskets, screws and washers before you operate sprayer.

<b>CAUTION</b>
<ul style="list-style-type: none"> <li>• Do not run sprayer dry for more than 30 seconds. Doing so could damage pump packings.</li> <li>• Protect the internal drive parts of this sprayer from water. Openings in the cover allow for air cooling of the mechanical parts and electronics inside. If water gets in these openings, the sprayer could malfunction or be permanently damaged.</li> <li>• Prevent pump corrosion and damage from freezing. Never leave water or water-base paint in sprayer when its not in use in cold weather. Freezing fluids can seriously damage sprayer. Store sprayer with Pump Armor to protect sprayer during storage.</li> </ul>

# Troubleshooting

## 1. Common Problem of Equipment

Problem	What To Check <i>(If check is OK, go to next check)</i>	What To Do <i>(When check is not OK, refer to this column)</i>
<b>Motor Won't Operate</b>		
Basic Fluid Pressure	1. Pressure control knob setting. Motor will not run if set at minimum (fully counter-clockwise).	1.Slowly increase pressure setting to see if motor starts
	2. Spray tip or fluid filter may be clogged.	2.Relieve pressure ,then Then clear clog or clean gun filter
Basic Mechanical	1. Pump frozen or hardened paint	1.Thaw sprayer if water or water-based paint has frozen in sprayer. Place sprayer in warm area to thaw. Do not start sprayer until thawed completely. If paint hardened (dried) in sprayer, replace pump packings.
	2. Displacement pump connecting rod pin. Pin must be completely pushed into connecting rod and retaining spring must be firmly ingroove or pump pin.	2. Push pin into place and secure with spring retainer.
	3. Motor. Remove drive housing assembly.	3. Replace motor if fan won't turn.
Low Output	1. Worn spray tip.	1.Relieve pressure, Replace tip
	2. Verify pump does not continue to stroke when gun trigger is released.	2. Service pump.
	3. Prime valve leaking.	3. Relieve pressure, Then repair prime valve.
	4. Suction tube connections	4. Tighten any loose connections. Check o-ring on suction tube.
	5. Electric supply with volt meter. Meter must read 220-240 Vac or 110V(According to models). Low voltages reduce sprayer performance.	5. Reset building circuit breaker; replace building fuse. Repair electrical outlet or try another outlet.
	6. Extension cord size and length.	6. Replace with a correct, grounded extension cord.
	7. Leads from motor to circuit board for damaged or loose wire connectors. Inspect wiring insulation and terminals for signs of overheating.	7. Be sure male terminal pins are centered and firmly connected to female terminals. Replace any loose terminals or damaged wiring. Securely reconnect terminals.
	8. Worn motor brushes which must be greater than 1/4 in. (6 mm).	8. Replace brushes.
	9. Motor brushes binding in brush holders.	9. Clean brush holders. Remove carbon dust by using compressed air to blow out brush dust.
	10. Low stall pressure. Turn pressure control knob fully clockwise.	10. Replace pressure control assembly.
	11. Motor armature for shorts by using an armature tester (growler) or perform spin test,	11. Replace motor

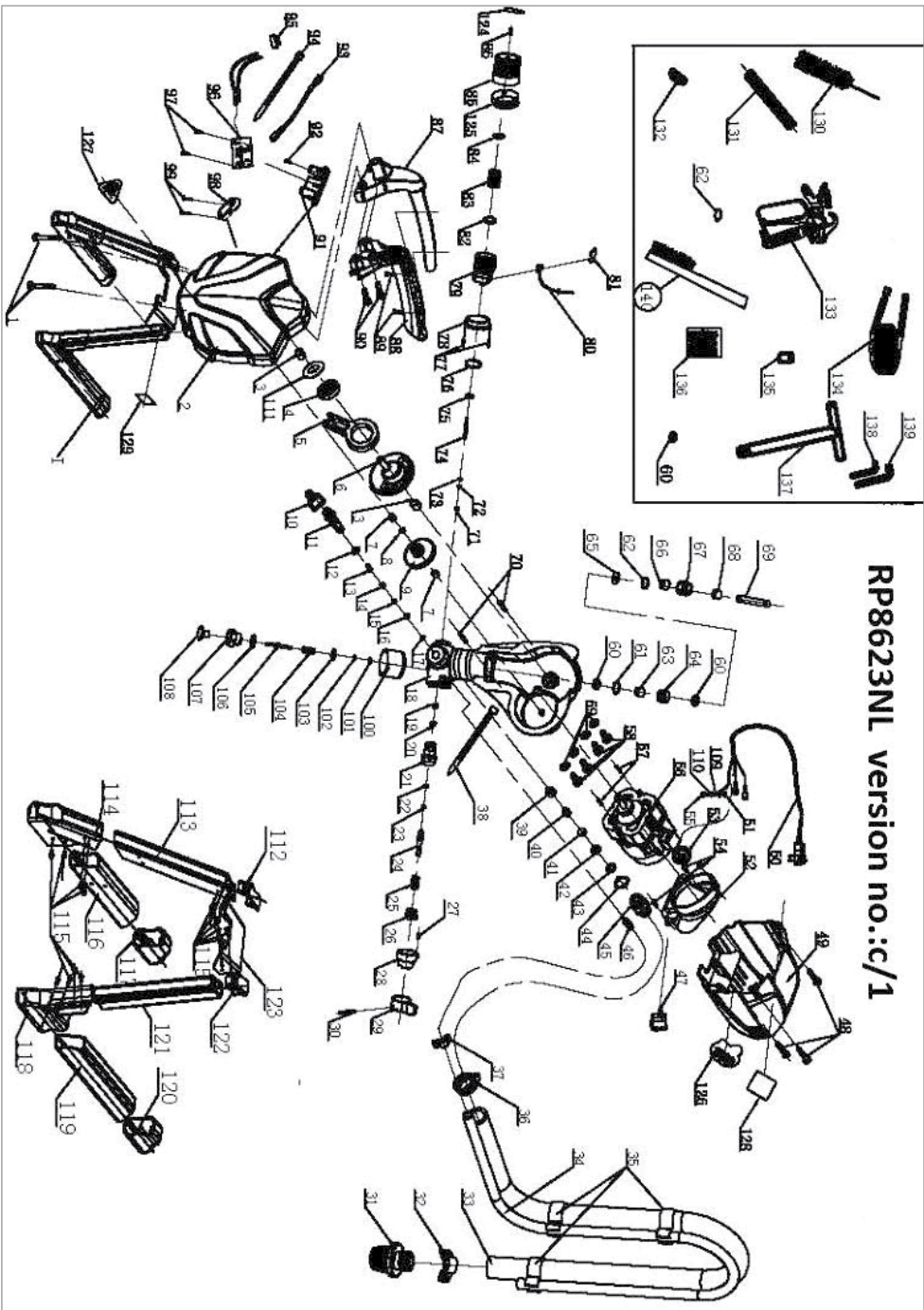

RP8623NL version no.:c/1

## Parts list

No.	Description	Qty.	No.	Description	Qty.	No.	Description	Qty.
1	Hex Bolt M6*20	2	45	Paint Input adaptor	1	89	Hex bolt M4*10	2
2	Pump cover	1	46	Pressure relief plug	1	90	Hex bolt M6*25	2
3	Output Gear bushing	2	47	Power switch	1	91	PCB supporter	1
4	Rolling bearing	1	48	Hex bolt M5*14	3	92	Bolt M4*10	1
5	Output pole	1	49	Housing	1	93	Wire connector	1
6	Gear	1	50	Power plug	1	94	Nylon Cable tie	1
7	Gear bushing	2	51	Locking ring	1	95	Safety cover	1
8	Gear washer	1	52	Exhust tube	1	96	PCB Assembly	1
9	Output gear	1	53	Wire Fastening seat	1	97	Tapping screw	2
10	Screw	1	54	Screw 3.5*10	3	98	Power cord fixer	1
11	Paint outlet	1	55	Bolt M4*10	1	99	Bolt M4*20	2
12	O-ring 10*8	1	56	Motor assembly	1	100	Shield	1
13	Output spring	1	57	Pin 3*12	2	101	O-ring 2.4*1.8	1
14	Mandrel	1	58	Hex bolt M5*14	4	102	Stopper	1
15	Steel ball 6.4	1	59	Spring washer 5	4	103	Copper gasket	1
16	Seal seat	1	60	Joint stopper	2	104	Touch control spring	1
17	Output washer	1	61	O-ring	1	105	Touch control pole	1
18	Pump	1	62	O-ring 22.5*1.8	1	106	O-ring 10*1.5	1
19	Plastic washer	1	63	Stopper sleeve	1	107	Touch control seat	1
20	Screw seat insert	1	64	Position washer	1	108	Touch control stem	1
21	Pressure relief valve seat	1	65	Copper washer	1	109	Flat washer 4	1
22	O-ring 5*1.8	1	66	Felt	1	110	Spring washer 4	1
23	Ring	1	67	Connector seat	1	111	Pole stopper	1
24	Pressure relief valve pole	1	68	Copper guide bushing	1	112	Pump frame assembly	1
25	Spring	1	69	Connector	1	130	Bush	1
26	Spring seat	1	70	Pin 5*12	2	131	Filter	1
27	Pin 3*8	1	71	Lock sleeve	1	132	Rubber stopper	1
28	Switch seat	1	72	White seal	1	133	Airless paint sprayer	1
29	Switch knob	1	73	sealing washer	1	134	Paint hose 7.6m	1
30	Pin 2.5*25	1	74	Pressure control pin	1	135	Socket 22mm	1
31	Filtrate seat assembly	1	75	O-ring 8.8*1.9	1	136	Manual	1
32	Inlet pipe lock ring	1	76	O-ring 27*2.4	1	137	Wrench	1
33	Suction tube	1	77	Hex bolt M3*10	2	138	Hex wrench 4mm	1
34	Priming tube	1	78	Pressure seal cover	1	139	Hex wrench 5mm	1
35	Clip	1	79	Micro switch	1	140	Bush	1
36	Large clamp	1	80	Micro switch cover	1			
37	Small clamp	1	81	Pressure control switch	1			
38	Nylon cable tie	1	82	Switch cover	1			
39	Inlet spring holder	1	83	Pressure adjusting spring	1			
40	Input spring	1	84	Spring pusher	1			
41	Steel ball 12.7	1	85	Pressure knob	1			
42	Input seal	1	86	Pressure control bolt	1			
43	Input washer	1	87	Up handle	1			
44	O-ring 17*1.8	1	88	Below handle	1			

## Sealing ring replace:

1. Removed the rear cover with 5" allen wrench.
2. Loosen two screws on pump frame with 5" allen wrench, the pump to be removed from the pump frame.
3. Loosen four screws which connector the pump and pump cover with 4" allen wrench.
4. Open the pump cover, take out the connecting rod component and the gear.
5. Screw out the connector with special sleeve.
6. Carefully check the piston rod and seal and o-ring and other parts for wear and scratches, if any, should be replaced immediately, (head the ball into the connector seat, can remove piston, sealing ring, etc.)
7. With special sleeve screw the connector to pump body and tighten in place.
8. Put the connector assembly and gear into pump hosing.
9. Locking pump cover and pump housing with screw, then pump loaded on the frame, and cover the rear cover.
10. Assembled the Suction tube and Priming tube component.
11. According to operating Instructions steps to activate and check the equipment without dripping.

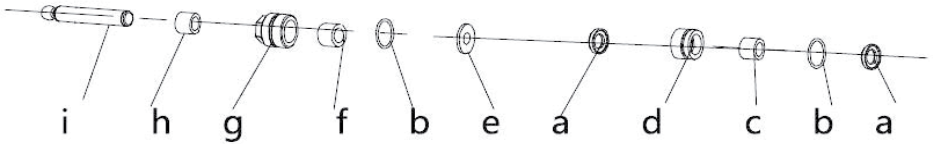

a. Joint stopper	b. O-ring 22.5*1.8	c. Stopper sleeve
d. Position washer	e. Copper washer	f. Felt
g. Connector seat	h. Copper guide bushing	i. Connector

### Note:

1. All components apply a little oil before assembled.
2. Even if a sealing ring is damaged, must be replaced the whole repair parts.

## 230V Airless Sprayer Electrical Installation Drawing

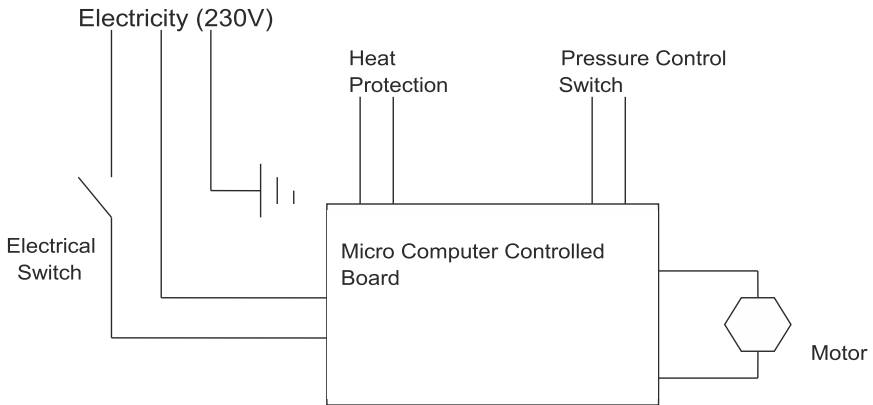

Distributor: DVA A/S Marielundvej 48C, 2730 Herlev, Denmark